

# evoke®

## INSTALLATION INSTRUCTIONS

### SURGE

### RIVERS AND ARCHWAYS COLLECTION

#### PRODUCT USE

Evoke SURGE Waterproof Composite Core (WCC) flooring meets the industry's 24 hour waterproof standards ANSI/NALFA LF-01. Evoke WCC flooring is for indoor use in residential applications, this product may be used in all areas including 'wet rooms' (bathroom, kitchen, laundry). When installing in wet rooms, follow the special instructions in the "Completing the Installation" section. Surge should not be installed in saunas, shower stalls or any area where it will be exposed to dampness or high humidity on a regular basis. In commercial applications, Surge may be used in locations where moderate to heavy customer traffic is expected, including but not limited to offices, retail stores and restaurants, medical/dental clinics, salons, etc. Surge should not be installed in locations where there is frequent exposure to spilled liquids (bars, public washrooms, etc.) or heavy rolling loads (warehouses, hospitals, big box stores, etc.)

#### MOISTURE PROTECTION

Evoke Surge floors are guaranteed to withstand exposure to topical surface moisture and liquid for 24 hours or more without damage to the floor, however, it is recommended that any spilled food, drink or other liquid be cleaned up as quickly as possible. Place trays or mats under any standing containers like plant pots or water dishes. Installations in 'wet rooms' (bathroom, kitchen, laundry) must have waterproof silicone caulking applied wherever the floor meets a vertical object (molding, baseboard, cabinetry) or sits under a standing fixture (sink, toilet, doorframe) as described in the installation instructions. The floor is not warranted against excessive exposure to liquid such as flooding, excessive mopping, burst pipes, etc. The floor is not warranted against any exposure to moisture originating in the substrate.

These are abridged instructions for reference only. For complete installation instructions please visit [evokeflooring.com](http://evokeflooring.com).

Evoke flooring can be installed

- in rooms on, above or below ground level
- over plywood, OSB, or concrete subfloor
- directly over most existing hard surface flooring
- over radiant heating systems

#### CLIMATE CONTROL

Conditions at the job site must be maintained with the temperature between 60-80°F (16-26°C) and humidity at 30-50% before, during and after the installation.

#### SUBFLOOR PREPARATION

All subfloors must be clean, dry, structurally sound and flat to within 3/16" in 10'. All subfloors must be tested for moisture content, and the moisture content of both subfloor and flooring must be within allowable limits before commencing installation.

#### VAPOR BARRIER & UNDERLAY

When installing laminate over a concrete subfloor that is either on, above, or below-grade, a Class I perm rated vapor barrier must be placed between the laminate and the concrete subfloor.

As listed by the North American Laminate Flooring Association (NALFA), some acceptable vapor barriers/retarders over concrete include:

1. A minimum 6 mil construction grade polyethylene film or other impermeable similar material.

The above listed vapor barrier/retarders should be installed in the following manner:

- Lay a single layer of poly over the entire subfloor.
- Allow a 12 inch overlap between seams, and seal the seams with duct tape along their entire length.
- Leave an excess of 4 inches of material extending up the wall at all outer edges and hold in place with blue or painter's masking tape. (This excess will be trimmed away later.)
- Next install an appropriate underlay over the entire subfloor surface. The seams should butt, not overlap.

2. An NALFA certified underlayment providing a class I perm rated moisture protection and having a vapor transmission factor of less than 3 lbs/1000 sq. ft/24 hours. Evoke recommends Pro Series Komfort + 30 or 50 as suitable types of underlay for this purpose.

3. On Evoke Surge products with a pad already attached. No additional underlay is required. Additional underlay used on pad attached products may cause excessive deflection and potentially result in flooring failures or other issues. When installing a pad attached Surge or other laminate floor over a concrete sub floor a class 1 vapor barrier is required. Use the recommended 6 mil. polyethylene as described above.

4. For plywood subfloors where 6 mil poly is not required, the use of an underlayment is required (for products that do not have a pad-attached.) Our Komfort + collection are ALL approved for this purpose, however any other underlayment must be approved for use, with laminate flooring, from the supplier of the underlayment.

#### EXPANSION SPACE

Allow 3/8" (10mm) expansion space around the entire perimeter of the floor. Also leave expansion space where the flooring will meet any vertical obstacle, such as stairs, cabinets etc.

## How to Install

OPEN 1 OR 2 PACKAGES OF FLOORING AND INSPECT BOARDS TO ENSURE THERE ARE NO MANUFACTURING DEFECTS. REMEMBER, FLOORING THAT HAS BEEN INSTALLED WILL BE DEEMED TO HAVE BEEN INSPECTED AND ACCEPTED BY THE INSTALLER AND CUSTOMER, EVEN IF THE CUSTOMER IS NOT PRESENT AT THE TIME OF INSTALLATION.

Note: The patented Unilin locking joint system used in this flooring enables boards to be fitted together in two ways; Angle-In Installations & Flat Installation.

#### ANGLE-IN INSTALLATION:

Hold the new board at an angle of 20 to 30° to the previously installed board, and engage the tongue and groove joint at the butt-end of the boards. Move the new board gently up and down while exerting gentle pressure along the long side of the board. The long side joint will click into place, locking the joint. This is the easiest method for installation and should be used for most boards.

#### FLAT INSTALLATION:

The new board is laid flat on the floor aligned to the previously installed board and, using a specially designed Unilin tapping block (available from your dealer) the boards are tapped together gently until the joint locks. Do not try to close the joint with a single hit on the block; use a series of light taps until the joint closes completely. It is important to avoid damaging the locking system. Broken locking systems are not covered under warranty. This method should only be used in situations where the Angle-In method is not feasible, or for tapping closed joints that have not locked completely.

Select your starting wall and check for straightness. Decide in which direction you want to install (evoke can be installed left to right, or right to left). This manual will describe a left-to-right installation.



Waterproof Core



30 Year Residential  
5 Year Commercial  
Warranty







Wear Rated For Heavy  
Duty Residential and  
Commercial Use



Superior Scratch  
Stain and Abrasion  
Resistance



LAMINATE FLOORING	 This laminate flooring was fabricated with t-MDF compliant with EPA TSCA Title VI and CARB ATCM 93120 Phase 2
	 TSCA TITLE VI compliant / conforme au titre VI de la TSCA
	Metropolitan Hardwood Floors is required by California state law to provide the following "California Proposition 65" statement for the exclusive use of California residents and/or for sales in California.  WARNING: Drilling, sawing, sanding, or machining wood products can expose you to wood dust, a substance known to the State of California to cause cancer. Avoid inhaling wood dust or use a dust mask or other safeguards for personal protection. For more information go to <a href="http://www.P65Warnings.ca.gov/wood">www.P65Warnings.ca.gov/wood</a>
	COMPLIANT WITH ALL FORMALDEHYDE EMISSION REGULATIONS

# evoke®

## INSTALLATION INSTRUCTIONS SURGE RIVERS COLLECTION

Working from multiple coxes to ensure a good mix of patterns, begin at the left hand end of the starting wall. Have a quantity of 3/8" (10mm) spacers handy. Begin with a full board. Saw off the tongue on both the long and short sides of the board, and place the board with the sawn butt end against the wall on the left, and the sawn long side facing the starting wall, but set out about two feet from the starting wall. Insert a spacer at the left end of the board and nudge the board against the wall.

Take a shorter board to begin the second row, and angle in to position against board 1, fitting together the long side joint. Place a spacer at the left hand end of the second board. Note: Lay a heavy object like a full box of evoke flooring on the end of the first two boards to help keep them in position while you continue the installation. Install board 3. Hold it at angle and fit the butt-end joint into the end of board 2. Drop board 3 slightly to engage the butt joint, then lift board 2 & 3 together and move gently up and down while pressing forward until the long side joint of board 3 locks into board 1.

**Note: Ensure the minimum length of the starting boards in each row is 8" (300mm) and the end joints are staggered by minimum 8" or 1 board width.**

Take board 4 and saw off the tongue joint on the long side only. Hold it at angle and fit the butt-end joint into the end of board 1. Drop board 4 slightly to engage the butt joint with board 1, then lift board 1 & 4 together and move gently up and down while pressing forward until the long side joint of board 4 locks into board 3. (Kneeling on board 3 while you do this will help hold everything in place.)

Install board 5 in the same fashion as board 3. Install board 6 in the same fashion as board 4. Continue until you have completed two full rows. At the end of the row, cut boards to fit, but remember to leave expansion space at the end of the row as well.

**Note: Start rows with a variety of different lengths of boards. You can also use off cuts from previous row ends to begin new rows, as long as they are a minimum of 8" or 1 board width. Remember to stagger end joints by a minimum two board-width.**

To begin the third row, hold the first board at a 30° angle and insert the long side tongue into the long side groove of the previous row, then lower into place. Ensure the left hand edge is aligned with the previous row and put an expansion spacer between the left hand end of the board and the wall. Use the Angle-In installation method described above to install the rest of the boards to complete the row. Continue installing in this manner until you have completed three or four full rows. Insert a series of expansion spacers along the starting wall and slide the assembled flooring against the starting wall.

If a board cannot be angled into place – if it is under a door jamb or other obstacle, for example – use the flat installation method. Lay the board flat on the floor and, using a special Unilin tapping block and hammer, gently tap along the edge until the joint is closed. Tap gently and repeatedly; do not use excessive force. To close a butt-joint, use a series of light taps. To close a long side joint, tap gently and repeatedly along the entire length of the joint.

Continue with the installation throughout the rest of the room. When you get to the final row, measure the distance to the far wall and 'rip' a row of boards to fit the gap – remember to leave 3/8" (10mm) expansion space against the far wall. For the final row, rip a series of boards to the required width and install as illustrated. The use of T&G adhesive is required whenever boards are modified.

That's it! Your new evoke floor is installed! To finish the job, remove the expansion spacers. Install moldings, trim and transitions. Moldings and transitions must be affixed either to the subfloor or to the wall – never to the flooring itself.

Before you move furniture onto the floor, take a moment to protect your new floor by putting felt pads on all furniture and accessories.

FOR COMPLETE INSTALLATION INSTRUCTIONS, INCLUDING CARE & MAINTENANCE AND PRODUCT WARRANTY INFORMATION: VISIT [EVOKEFLOORING.COM](http://EVOKEFLOORING.COM)

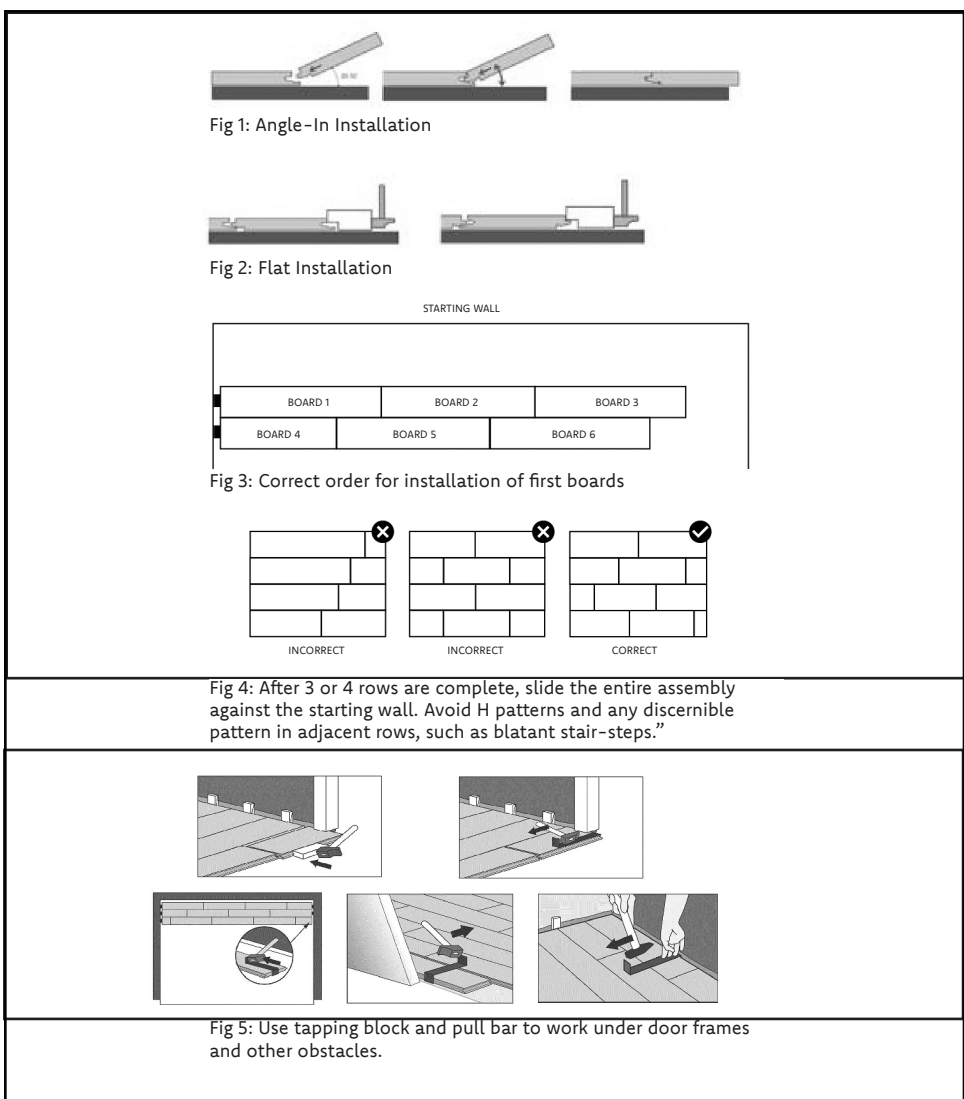

FOR MORE INFO, VISIT:  
[evokeflooring.com](http://evokeflooring.com)